

RoHS Compliant

REV.	ECN NO	LTR	DESCRIPTION	REVISER	DATE
A/0			Initial_release.	JN	2021.4.16

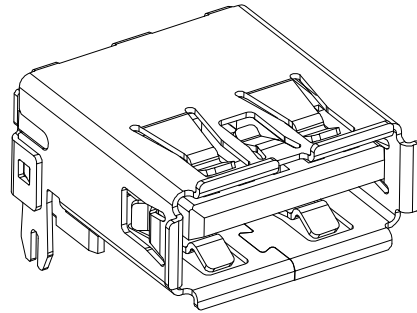
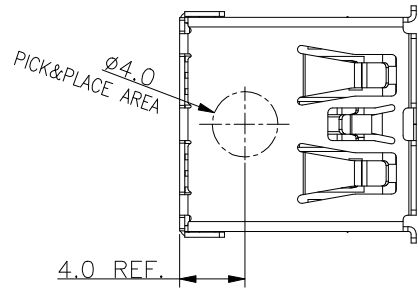

NOTE:

1. MATERIAL:
  - 1.1 INSULATOR: LCP+30%GF, UL94V-0, COLOR: BLUE, HF REACH
  - 1.2 CONTACT: COPPER ALLOY.
  - 1.3 SHELL: SUS201
2. PLATING:
  - 2.1 CONTACT: GOLD 30u" PLATED ON CONTACT AREA  
80u" Min. TIN PLATED ON SOLDER TAIL  
50u" Min. NICKEL UNDER-PLATED
  - 2.2 SHELL: 50u" Min. NICKEL PLATED OVERALL
3. CHARACTERISTICS:
  - 3.1 ELECTRICAL CHARACTERISTICS:  
CONTACT RESISTANCE: 30mΩ MAXIMUM  
CONTACT CURRENT RATING: 1.5A  
DIELECTRIC WITHSTANDING VOLTAGE: 500 V R.M.S.  
INSULATION RESISTANCE 1000 MEGOHMS MIN  
OPERATING TEMPERATURE: -25°C ~ +85°C
  - 3.2 MECHANICAL:  
MATING FORCE: 3.57Kg.Max.  
UNMATING FORCE: 1.02Kg.Min.
4. DESIGN STANDARD ACCORDING TO USB\_3.0 SPECIFICATION.

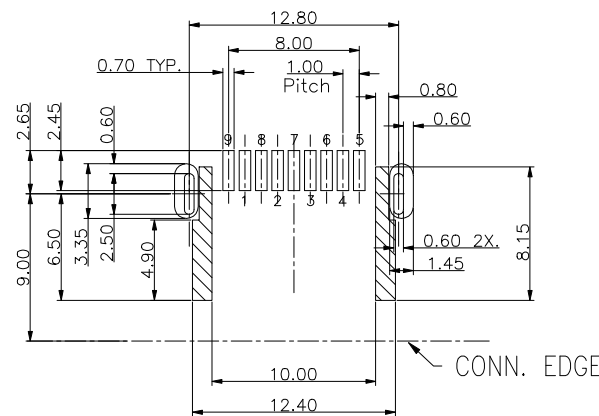
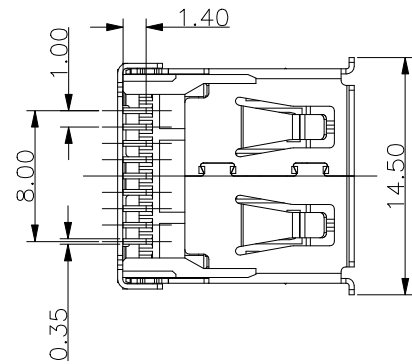
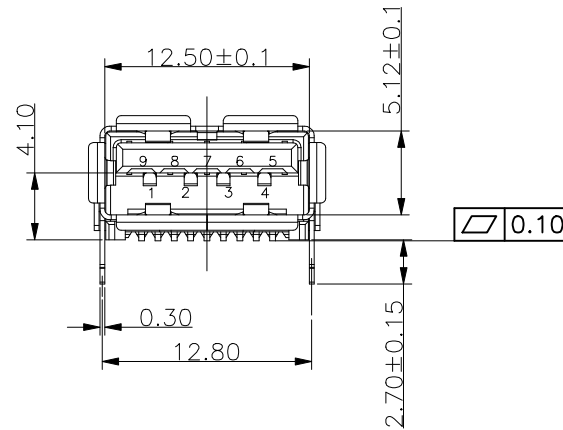
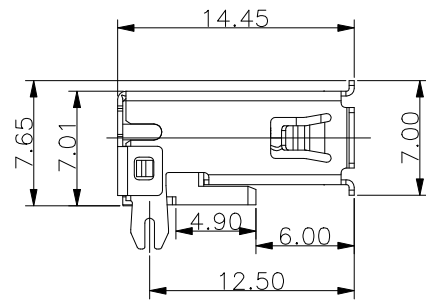

PIN ASSIGNMENT.

PIN NO.	1	2	3	4	5	6	7	8	9	SHELL
SIGNAL NAME	VBUS	D-	D+	GND	SSRX-	SSRX+	GND_DRAIN	SSTX-	SSTX+	SHIELD

RECOMMENDED PCB LAYOUT  
TOP VIEW, TOL: ±0.05MM  
KEEP OUT AREA

图号 (DWG NO)	G-319-S1-560	单位 (UNIT):	MM		显赫电子科技有限公司 XianHe Electronic Technology co., Ltd.
类别 (DWG TYPE)	BRKE DWG	比例 (SCALE):	1:1		
版次 (REV):	A/0	页次 (PAGE):	1/1	TEL: 0769-89138899 FAX: 0769-89100950	
设计 (DESIGN)	JN	未注公差 TOLERANCE UNSPECIFIED			
审核 (CHECKED)		.X.X ± 0.38 .X.XX ± 0.20 .X.XXX ± 0.10 " ± 5' .X.X' ± 2'		品名 (ITEM NO)	ASP A/F 90度SMT 短体L=14.45mm (外壳有卷边) LCP兰色 半金雾锡30u" 不锈钢镀镍, 载带包装 无卤
核准 (APPROVED)				料号 (PART NO)	601ASPS2HF