

RoHS Compliant

REV.	ECN NO	LTR	DESCRIPTION	REVISER	DATE
A/0			Initial_release.	GENG	2020.04.13

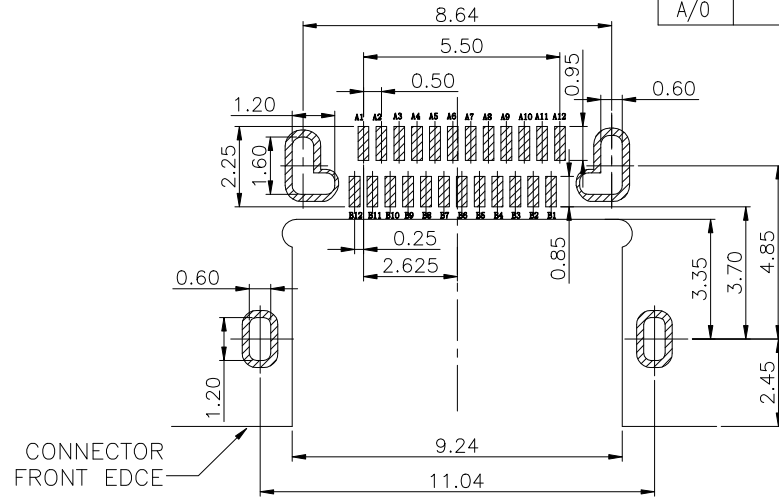

RECOMMENDED P.C.B. LAYOUT
TOLERANCE UNSPECIFIED ±0.05mm

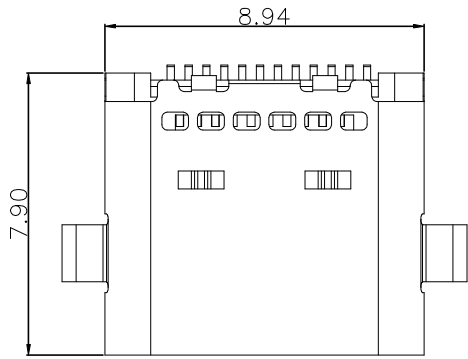
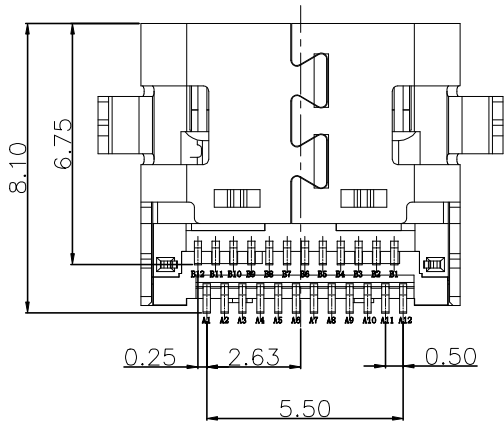
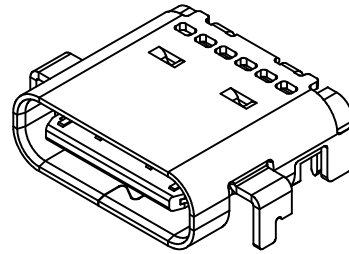
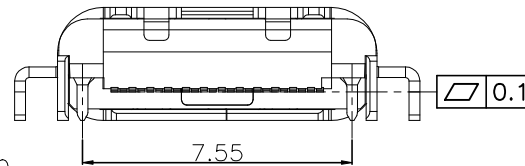
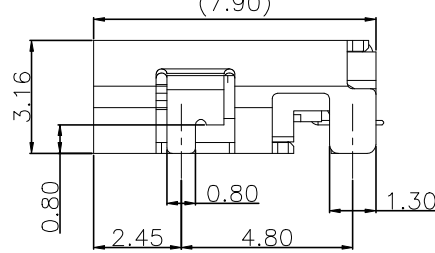
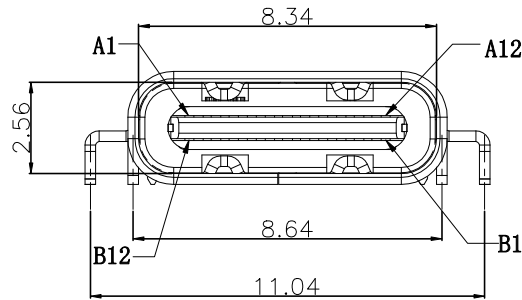

1. CHARACTERISTICS:
- 1.1 ELECTRICAL CHARACTERISTICS;
CONTACT RESISTANCE: 40mΩ MAXIMUM
CONTACT CURRENT RATING: 1.5A
DIELECTRIC WITHSTANDING VOLTAGE: 100 V R.M.S.
INSULATION RESISTANCE 100 MEGOHMS MIN
OPERATING TEMPERATURE: -30°C ~ +85°C
- 1.2 MECHANICAL:
MATING FORCE: 5-20N.
UNMATING FORCE: 8-20N.
DURABILITY: 10000 CYCLES

PART NUMBER INFORMATION
319CF-K-XX-X-SN-HF

Hsg. color: K: Black
Terminal plating:
1: Gold flash
4: Gold 15u"
6: Gold 30u"

REV

Halogen Free

Pin	Signal Name	Mating Sequence	Pin current	Pin	Signal Name	Mating Sequence	Pin current
A1	GND	First	1.25A	B12	GND	First	1.25A
A2	SSTXp1	Second	0.25A	B11	SSRXp1	Second	0.25A
A3	SSTXn1	Second	0.25A	B10	SSRXn1	Second	0.25A
A4	Vbus	First	5A	B9	Vbus	First	5A
A5	CC1	Second	1.25A	B8	SBU2	Second	1.25A
A6	Dp1	Second	0.25A	B7	Dn2	Second	0.25A
A7	Dn1	Second	0.25A	B6	Dp2	Second	0.25A
A8	SBU1	Second	0.25A	B5	CC2	Second	0.25A
A9	Vbus	First	5A	B4	Vbus	First	5A
A10	SSRXn2	Second	0.25A	B3	SSTXn2	Second	0.25A
A11	SSRXp2	Second	0.25A	B2	SSTXp2	Second	0.25A
A12	GND	First	1.25A	B1	GND	First	1.25A
SHELL	GND			SHELL	GND		

项目	品名	材质	描述	备注	
1	上排Molding	塑胶	LCP	UL94V-0, 黑色	1
		端子	C18400R-H T=0.12	接触区: 高温可焊金(见料号说明)	1
2	下排Molding	塑胶	LCP	UL94V-0, 黑色	1
		端子	C18400R-H T=0.12	接触区: 高温可焊金(见料号说明)	1
3	二次Molding	LCP	UL94V-0, 黑色	1	
4	前壳	SUS304, T=0.3	高温可焊镍: 30U" min.	1	
5	EMC片	SUS304, T=0.1	/	2	
6	中夹片	SUS304, T=0.2	/	1	

图号 (DWG NO)	G-319-S1-627	单位 (UNIT):	MM
类别 (DWG TYPE)	BRKE DWG	比例 (SCALE):	1:1
版次 (REV):	A/0	页次 (PAGE):	1/1
设计 (DESIGN)	GENG	未注公差 TOLERANCE UNSPECIFIED	
审核 (CHECKED)		.X.X ± 0.38	
核准 (APPROVED)		.X.XX ± 0.20	
		.X.XXX ± 0.10	
		X' ± 5"	
		X.X' ± 2"	

显赫电子科技有限公司
XianHe Electronic Technology co., Ltd.

TEL: 0769-89138899 FAX: 0769-89100950

品名 (ITEM NO)

料号 (PART NO) 319CFK46SNHF

USB C TYPE 母座 R/A, 沉板式, 两排SMT, L=7.9mm, 外壳四脚DIP, LCP黑色, 半金牙插30u", 白色透明载带包装(热封带), 无卤