

RoHS Compliant

REV.	ECN NO	LTR	DESCRIPTION	REVISER	DATE
A/0			Initial release.	ZXW	2015.07.16
A/1		▲	依实物更新Logo方向	HXM	2023.03.06

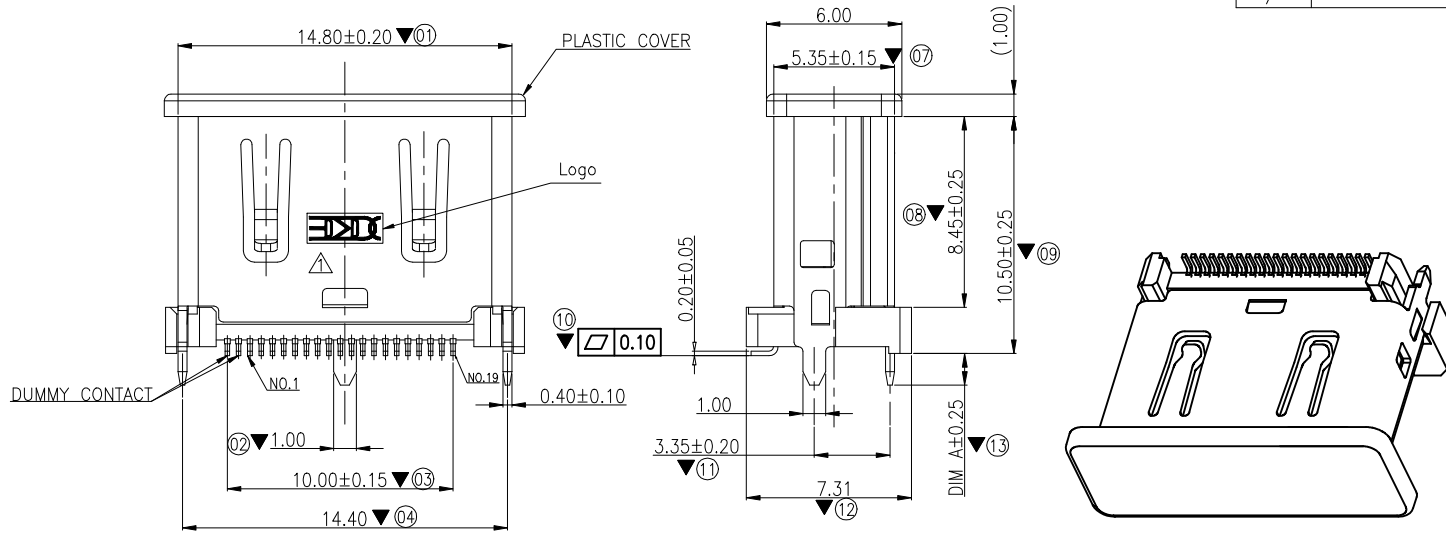

NOTE:

- MATERIAL:
 - INSULATOR:LCP+30%GF, UL94V-0, COLOR:OPTIONAL
 - COVER: LCP+30%GF UL94V-0 COLOR:OPTIONAL
 - CONTACT:BRASS C2680-H
 - SHELL:BRASS C2680-H
- PLATING:
 - CONTACT: SELECTIVE GOLD PLATED ON CONTACT AREA 100u" Min. MATTE TIN PLATED ON SOLDER TAIL 50u" Min. NICKEL UNDER-PLATED
 - SHELL:50u" Min. NICKEL PLATED OVERALL
- CHARACTERISTICS:
 - ELECTRICAL CHARACTERISTICS;
 - CONTACT RESISTANCE:30mΩ MAXIMUM
 - CONTACT CURRENT RATING:0.5A
 - DIELECTRIC WITHSTANDING VOLTAGE:500 V R.M.S.
 - INSULATION RESISTANCE 100 MEGOHMS MIN
 - OPERATING TEMPERATURE:-25°C ~ +85°C
 - MECHANICAL:
 - MATING FORCE: 4.5Kg.Max.
 - UNMATING FORCE: 1.0~4.0Kg.
- DESIGN STANDARD ACCORDING TO HDMI SPECIFICATION
- THE DIMENSIONS WITH "▼" MARK ARE CRITICAL AND SHOULD BE CONTROLLED BY QC.

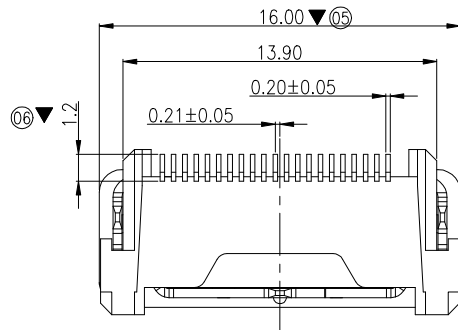
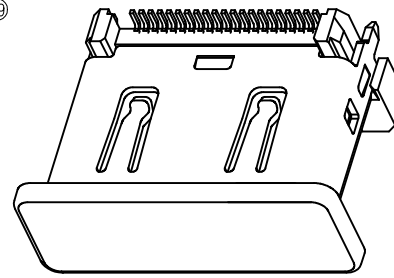

端子整体镀镍底50u" min.
 A 区镀金: Gold flash
 B 区镀金: 5u" min.
 C 区镀锡: 100u" min.

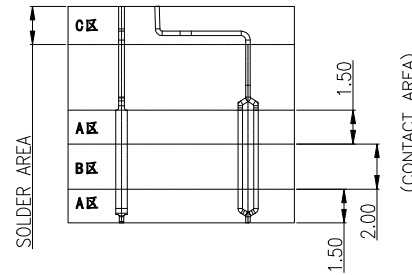

CONTACT PLATING DIAGRAM

PART NUMBER INFORMATION

30619F-X-X-C-XX-XX

HF: Halogen Free
 W/O HF: RoHS

Hsg.color: _____
 B:Blue(300 C)
 K:Black

DIM A OPTION	
P/N	Dim A
B9	3.20
C7	1.40

Terminal plating:

- Gold flash
- Gold 5u" on contact area.
- Gold 15u" on contact area.
- Gold 30u" on contact area.

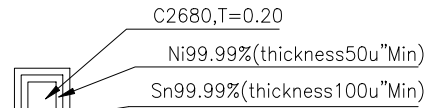
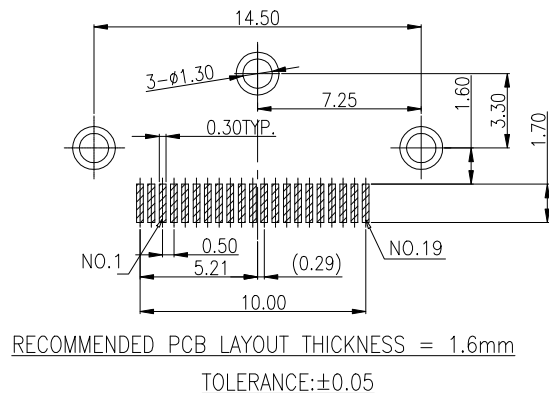

Contact Pin

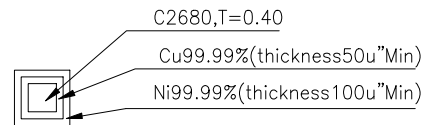

Shell Pin(L=1.40±0.20)

图号 (DWG NO)	G-331-S1-14	单位 (UNIT): MM
类别 (DWG TYPE)	SALES DWG	比例 (SCALE): 1:1
版次 (REV): A/1	页次 (PAGE): 1/1	未注公差 TOLERANCE UNSPECIFIED
设计 (DESIGN)	ZXW	.X.X ± 0.38
审核 (CHECKED)		.X.XX ± 0.20
核准 (APPROVED)		.X.XXX ± 0.10
		" ± 5'
		"X" ± 2'

显赫电子科技有限公司
 XianHe Electronic Technology co., Ltd.

TEL:0769-89138899 FAX:0769-89100950

品名 (ITEM NO)	HDMI A type rec 外壳 DIP式SMT 180度 带前盖 (21Pin)
料号 (PART NO)	30619F-X-X-C-XX-XX